

Manitoba
Family
Services



Notice of Agreement to Provide Placement

I, Kimberly Stephenson, of [REDACTED] agree to provide care for the child(ren) named below, according to the following conditions:

1. I will provide proper supervision of this child(ren) at all times.
2. I will make sure these child(ren) have proper food, clothing, and shelter while they are in my care.
3. I will provide consistent and caring discipline and will not nor allow any other person to use corporal punishment, harsh or degrading responses or deprive the child(ren) of basic need.
4. I will phone Child and Family Services for direction if any child appears sick or requires medical attention.
5. I realize that I am being trusted with the care of these child(ren) until further notice, and I will not let these child(ren) leave my care without the approval of Child and Family Services.
6. I am not aware of anyone living in this household who has been accused, charged, or convicted of a violent or sexual crime.
7. I am in agreement with the Agency performing the following checks on any adult(s) residing in my home:
 - a.) Criminal Records Search
 - b.) Abuse Registry Search
 - c.) Personal References
 - d.) Child Welfare Records
8. I am in agreement to participate, meet conditions of, and be licenced as a Child Specific Foster Home should the placement be of more than two weeks duration.
9. I understand that I shall receive \$ \$16.55 (Ages 0-10) \$20.55 (Ages 11-17) per day for the care of the child(ren) placed with me.
10. I will notify Winnipeg Child and Family Services if I have any trouble following these conditions.

CHILDREN TO BE PLACED:

1. Phoenix Sinclair D. O. B.: April 23/00
2. _____ D. O. B.: _____
3. _____ D. O. B.: _____
4. _____ D. O. B.: _____

[Signature]
Signature

[Signature]
Witness

[Signature]
Signature

July 29/03
Date

Mar 6/00/lg

CHILDREN'S FOSTER HOME PROVINCIAL REQUIREMENTS CHECK LIST

Date: July 29/03
 Name: Kimberly Stephenson
 Address: [REDACTED]
 Assessor: Stan W. Williams

Telephone: [REDACTED]
 Postal Code: [REDACTED]
 Office: 944-6778

Check "YES" or "NO", and/or include "COMMENTS" in the spaces provided.

REQUIREMENTS	YES	NO	COMMENTS (include whether this presents an immediate risk to child's safety)
1. The exterior of the house in good repair and satisfactorily maintained, i.e. paint, steps, sidewalks, yard.	✓		
2. The interior of the home is maintained in good repair with suitable furnishings and acceptable housekeeping standards.	✓		
3. Windows and doors used for ventilating purposes are fitted with screens.	✓		<i>all except for one</i>
4. The heating systems is in good repair and capable of heating the home to 22 degrees Celsius (72 ^o degrees Fahrenheit). (A carbon monoxide detector is recommended.)	✓		
5. Water of drinking quality is available, as well as hot and cold water for washing and bathing purposes.	✓		
6. Wastewater is disposed of in a sanitary manner.	✓		
7. Garbage is stored in proper containers and regularly collected or removed to a waste disposal ground.	✓		
8. If required, the water temperature in showers and bathtubs does not exceed 52°C (125°F) either by the installation of a water control system or by turning down the hot water temperature control. (Specify)	✓		
9. Toilets - a flush toilet or other acceptable type of toilet system in good repair. The door is lockable for privacy, but able to open from the outside in case of an emergency.	✓		

REQUIREMENTS	YES	NO	COMMENTS (include whether this presents an immediate risk to child's safety)
10. Adequate supplies for washing and bathing and age appropriate toiletries are available for the foster children.	✓		
11. Bedrooms must have at least one outside window openable from the inside without the use of tools or special knowledge. Window must provide an unobstructed opening with an area not less than .35m ² (3.8 sq ft) and with no dimension less than 380 millimetres (15 inches).	✓		
12. Bedrooms for children are separate for each sex for children over 5 years of age. Bedrooms shall have a floor area of at least 5.6m ² (60 square feet) and shall have at least 3.7m ² (40 sq ft) of floor area for each occupant.	✓		
13. Bed and mattress is suitable for foster child's age and size. Bed linen is clean, in good repair, and appropriate for climate.	✓		
14. Storage space is available for foster children's clothing and personal belongings.	✓		
15. Bedrooms are appropriately furnished and provided with suitable window coverings. Infant furnishings comply with requirements of the <i>Hazardous Products Act</i> (Canada).	✓		
16. Basement used for sleeping purposes for foster children in other than bi-level, split-level or similar type construction, which were designed for living accommodation. (If yes see Appendix A for requirements.)			N/A
17. Smoke alarms are located in the hallway(s) leading to the bedrooms or outside the bedrooms and on each floor level. Battery-operated alarms are tested monthly.	✓		
18. An approved 2A10BC-fire extinguisher is available for the kitchen area.	✓		Can recharge or replace just needs check
19. An emergency evacuation plan is in place. Emergency phone numbers are posted in a prominent place.	✓		

81

REQUIREMENTS	YES	NO	COMMENTS (include whether this presents an immediate risk to child's safety)
20. Firearms and ammunition are stored in accordance with the "Storage, Display, Handling and Transportation of Certain Firearms Regulations". Other hunting devices are also made inoperable and inaccessible to foster children.			N/A
21. Poisons and inflammable substances and cleaning supplies are clearly marked and properly stored.	<input checked="" type="checkbox"/>		
22. First aid kit equipped with the supplies specified in standards is available.	<input checked="" type="checkbox"/>		
23. Medication is stored, administered and recorded as required.	<input checked="" type="checkbox"/>		
24. Medical records and files are maintained as required by the placing or licensing agency.			To be determined
25. House pets are vaccinated if required by local authority and all other requirements met.			Fish / N/A
26. There are more than 10 residents (including the foster children). (If yes, there are additional requirements.)		<input checked="" type="checkbox"/>	
27. Stairs are provided with handrails.	<input checked="" type="checkbox"/>		

Mar 2000

LICENSING REQUIREMENTS	
1. Total number of people in the home cannot exceed 10 persons. (Please note number of adults)	
2. Total number of dependants (children & adults) who require care and supervision. (Maximum of 7)	
3. Total number of children under 5 years. (Maximum of 3)	
4. Total number of children under 2 years. (Maximum of 2)	

NOTE:

- Only 4 foster children can be placed in each foster home unless they are all siblings.
- These maximum occupant requirements include biological, adopted, foster, etc.
- Adults **can not** share a bedroom with children over the age of 2 years.
- Special approval from the Family Services, Child and Family Support Branch is necessary to exceed these standards.

Mar/00/fg

ONLY TO BE COMPLETED IF FOSTER CHILD WILL BE USING BASEMENT BEDROOM

Name: _____ Date: _____

Address: _____ Assessor: _____

The use of a basement bedroom that does not meet standards can "only" occur with approval of the RESOURCE PROGRAM MANAGER.

BASEMENT BEDROOM REQUIREMENTS CHECK LIST			
Check "YES" or "NO", and/or include "COMMENTS" in the spaces provided.			
REQUIREMENTS	YES	NO	COMMENTS
1. Does the basement have two exits? (Explain) (e.g. stairs to main floor, window, or doorway to outside, etc.)			
2. Is a window used as a second exit?			
3. If a window is used as the second exit, is the window below grade?			
4. If below grade, does it conform to #15(a) of the document titled "Approved Homes – Building/Fire Safety and Sanitation Standards?"			
5. Does the exit window provide an unobstructed opening or not less than four square feet?			
6. Does the exit window provide an opening with no dimension being less than 20 inches?			
7. Is the exit window hinged to swing on its vertical axis?			
8. Is the exit window readily openable from the interior without requiring keys, special devices or specialised knowledge of the opening mechanism?			
9. Is the exit windowsill more than 36 inches above the floor?			

BASEMENT BEDROOM REQUIREMENTS CHECK LIST			
Check "YES" or "NO", and/or include "COMMENTS" in the spaces provided.			
REQUIREMENTS	YES	NO	COMMENTS
10. If the sill is more than 36 inches above the floor, do the platform and stairs conform to #13(d) of the document titled "Approved Homes - Building/Fire Safety and Sanitation Standards?"			
11. Is the exit window through a bedroom? (Door cannot be lockable.)			
12. Is the exit through a furnace or storage room? (NOT PERMITTED)			
13. Is the exit window equipped with a label, which states "Emergency Exit" or other approved wording?			
14. Is there a second exit situated as a remotely as possible from the heating unit and the main stairway?			
15. Is there a smoke detector in the basement area near the bedroom?			
16. Is the basement bedroom enclosed?			
17. Does the basement bedroom have a floor covering, e.g. tile, carpet?			
18. Is the basement bedroom ceiling finished?			
RECOMMENDATIONS:			
19. That the furnace area be fire separated/enclosed by at least ½-inch drywall.			
20. Installation of a sewer line backup valve and sump pit with a pump.			

*****PLEASE PROVIDE A DIAGRAM SHOWING THE LOCATION OF THE STAIRWAY, EXIT WINDOW, OTHER WINDOWS, FURNACE AND ALL ROOMS.**

Mar. 2000

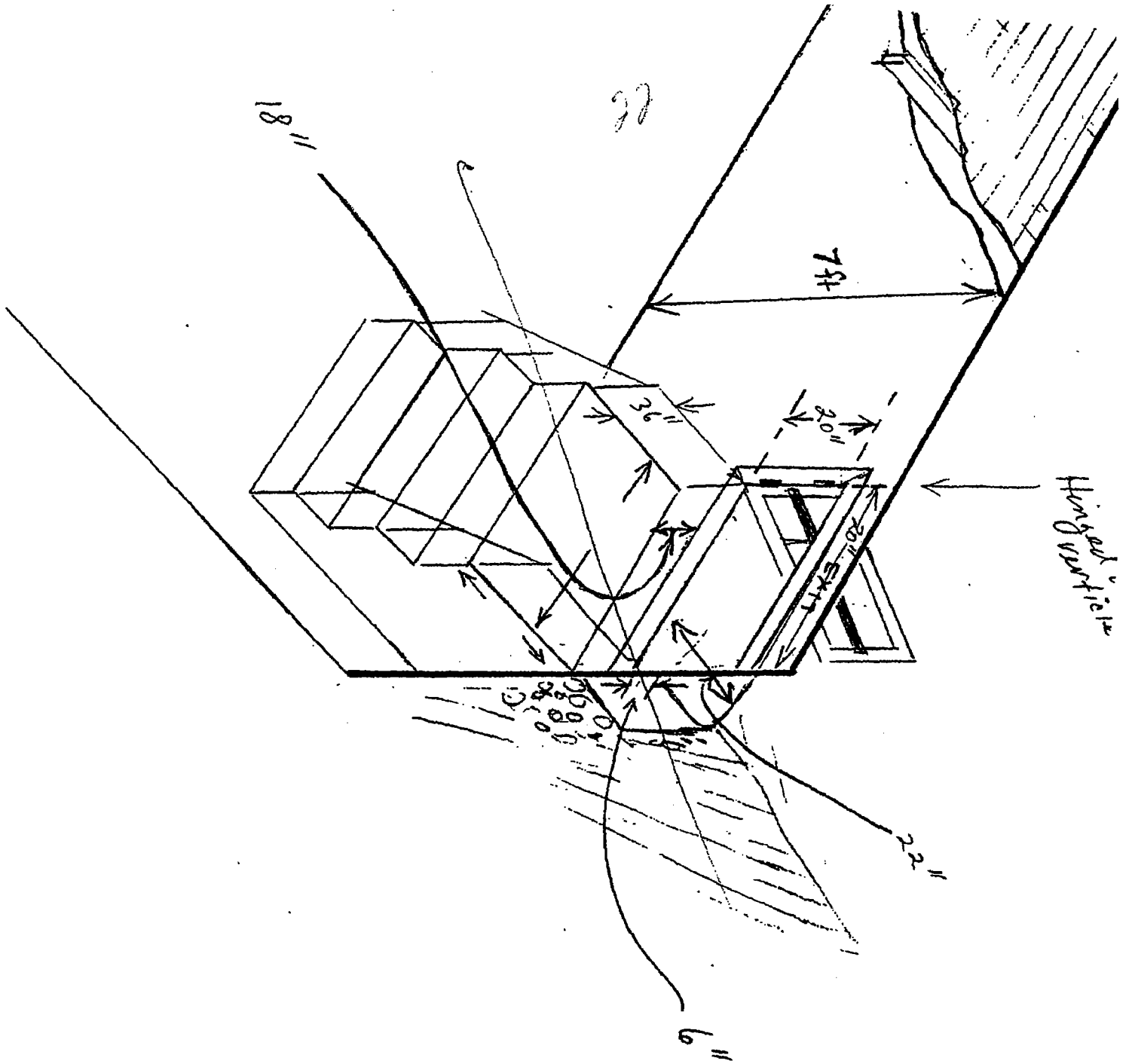

REFERENCE FORM

TO: Janya Jarvis Date: July 30/03
RE: Kimberly Stephenson

PLEASE COMMENT ON:

1. How long have you known the applicant(s); what is your relationship to them?

6 or 7 yrs. met through husband - friends

2. The stability of the applicant(s)' relationship/marriage?

even though separated they are still good friends

3. Applicant(s)' relationship with children?

Really good with kids,

4. Applicant(s)' ability to effectively discipline & set limits for a child. Please give an example you have observed.

Pretty good explains things - time outs, raises voice,

5. How would you assess the applicant(s)' abilities as a homemaker, friend, neighbour, or employee as far as you know?

Really good does well as a friend - as homemaker super clean

6. Would you or have you left your own children with the applicant(s) for an extended period of time?

yes - I have

7. What strength would contribute to their ability to foster children (ie. maturity, stability, humour, tolerant, accepting, energy level, parenting skills)?

Parenting skills & energy. Really good with compromise. Greats her like our kid.

8. State any concerns you may have about the applicant(s) (i.e.: alcohol or drug abuse, poor impulse control, prejudice, rigidity, financial difficulties, or any factors in their family, emotional, or medical background) that would effect their suitability as a care provider.

No

9. Would you recommend the applicant(s) as foster parents?

Yes. Oh yes definitely.

10. Is there any other information that you feel the agency should know about the applicant(s)?

Phoenix is better off there. Phoenix has been taken care of by RN & Ben for extended periods of time. Positive references.

PLEASE MAIL OR DROP OFF AT:

ATTENTION:

Winnipeg Child & Family Services
222 Provencher Blvd.
Winnipeg, MB R2H 0G5

Application for a Licence to Operate and Maintain a Children's Foster Home

Manitoba Family Services



AGENCY	Winnipeg Child & Family Services Foster Home Development Program 222 Provencher Boulevard Winnipeg, MB R2H 0G5	XV St ✓ SIS ✓	RECEIVED SEP 30 2003
---------------	-------------------------------------------------------------------------------------------------------------------------	---------------------	--------------------------------

TO BE COMPLETED BY APPLICANT(S)

NAME STEPHENSON KIMBERLY-Ann * STEPHENSON RONAN WAYNE
Surname Applicant's Given Names Surname Applicant's Given Names

ADDRESS [REDACTED] WPG MB
Street No. & Name or Box No. City, Town, Village, R.M. or L.G.D. Postal Code

* If rural location, Section _____ Township [REDACTED] Range _____

Best Access Route _____

Telephone Number [REDACTED] _____ _____ _____
(Home) (Applicant) (Business) (Applicant)

REFERENCES: Please list ³ four persons who are well acquainted with you and your home. Only one relative or business acquaintance should be used.

Name in Full	Full Mailing Address (Including Postal Code)	Telephone No.
[REDACTED]	[REDACTED] (?)	[REDACTED]
[REDACTED]	[REDACTED] (?)	[REDACTED]
[REDACTED]	[REDACTED]	[REDACTED]

By my/our signature, I/we hereby consent to the agency's conducting an investigation to assess this application, including a prior contact check, a child abuse registry check, and a criminal records check.

Signed at [REDACTED] this 23RD day of Sept, 2003

X [Signature]
Signature of Applicant

X [Signature]
Signature of Applicant

WHEN COMPLETED PLEASE FORWARD TO:

WINNIPEG CHILD & FAMILY SERVICES
Foster Home Development Program
222 Provencher Blvd.